

INOTube
LED conversion kit

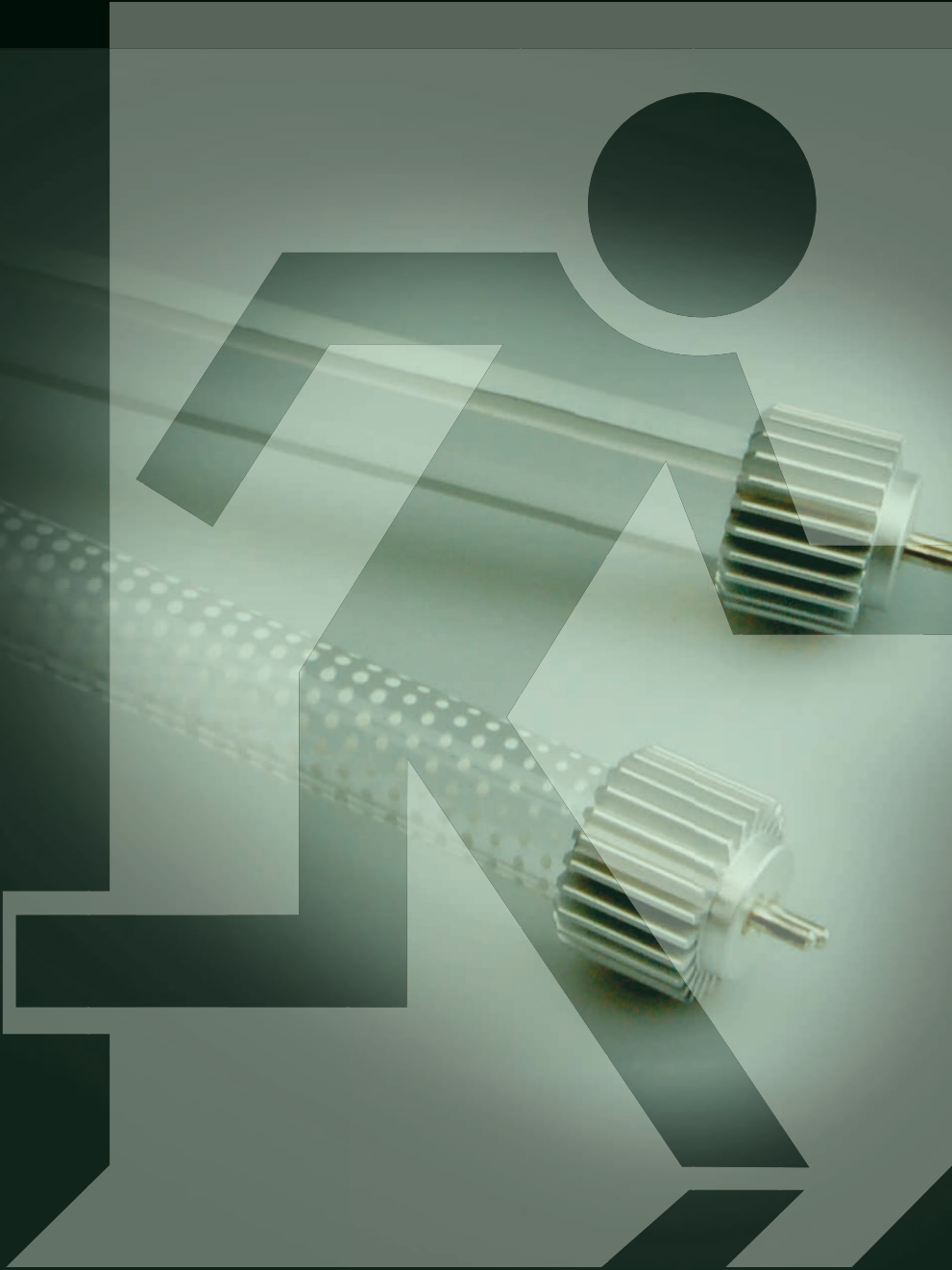

INOTube – The LED conversion kit for INOTEC emergency exit luminaires

Save costs and resources

By using the INOTube you're not only saving costs for purchasing new lamps. Also your maintenance costs are reduced significantly. Additionally you're saving valuable resources - for a better environment.

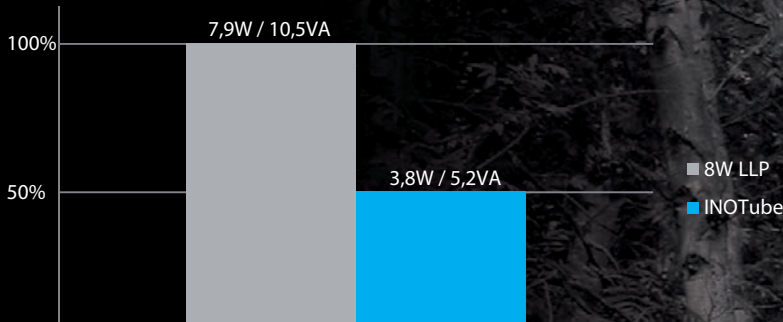

Low power consumption

The INOTube saves up to 50% power compared to a standard 8W fluorescent lamp. For bigger central battery systems you might be able to reduce the battery capacity at the next battery replacement. .

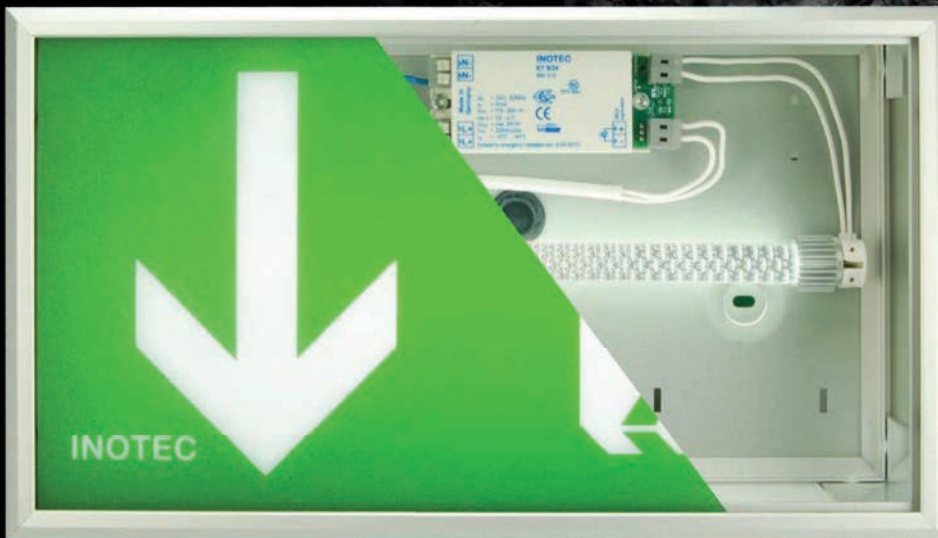

Standard compliant replacements

When upgrading your old 8W INOTEC emergency exit luminaires with INOTube you're still standard compliant. A manufacturer's certificate is obligatory. This can't be guaranteed with other 3rd party LED retrofits.

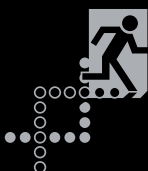

Make your emergency lighting fit for the future!

Existing 6W or 8W INOTEC emergency exit luminaires can be easily upgraded to modern LED technology with the new INOTube conversion kit.

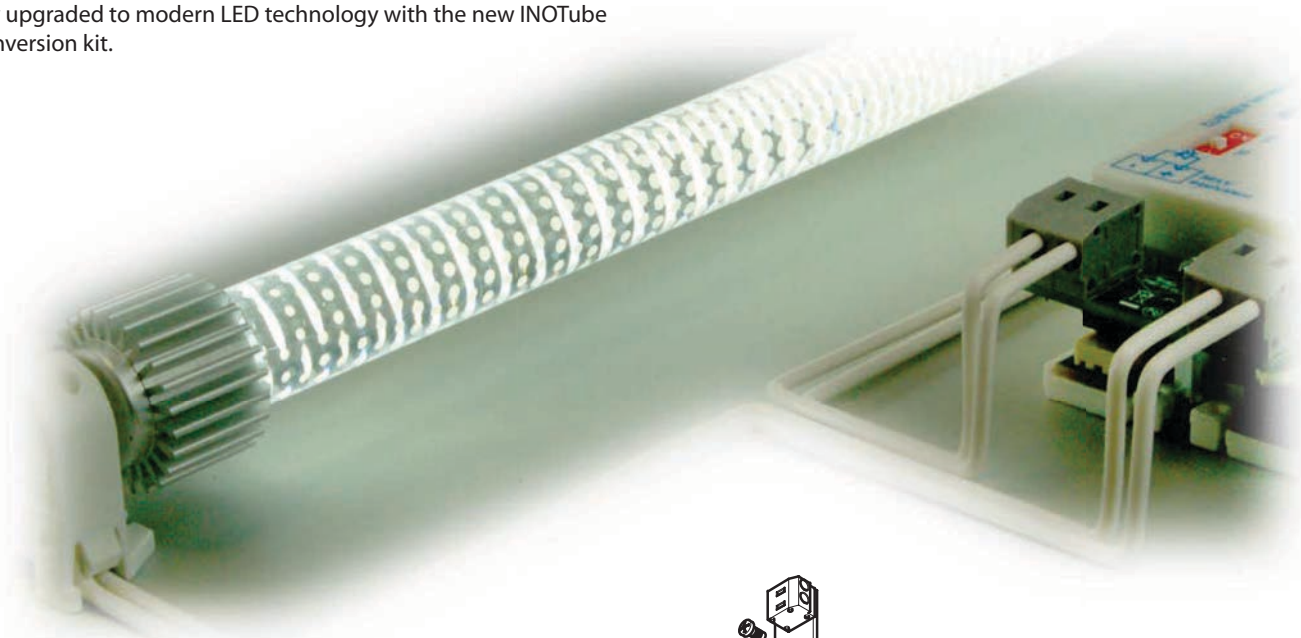

360° illumination by innovative edge-irradiation

The INOTube LED conversion kit is available in two different versions. INOTube 360° is suitable for single- and double-sided emergency exit luminaires, due its 360° illumination. INOTube 180° is specially designed for a homogenous illumination of edge lights.

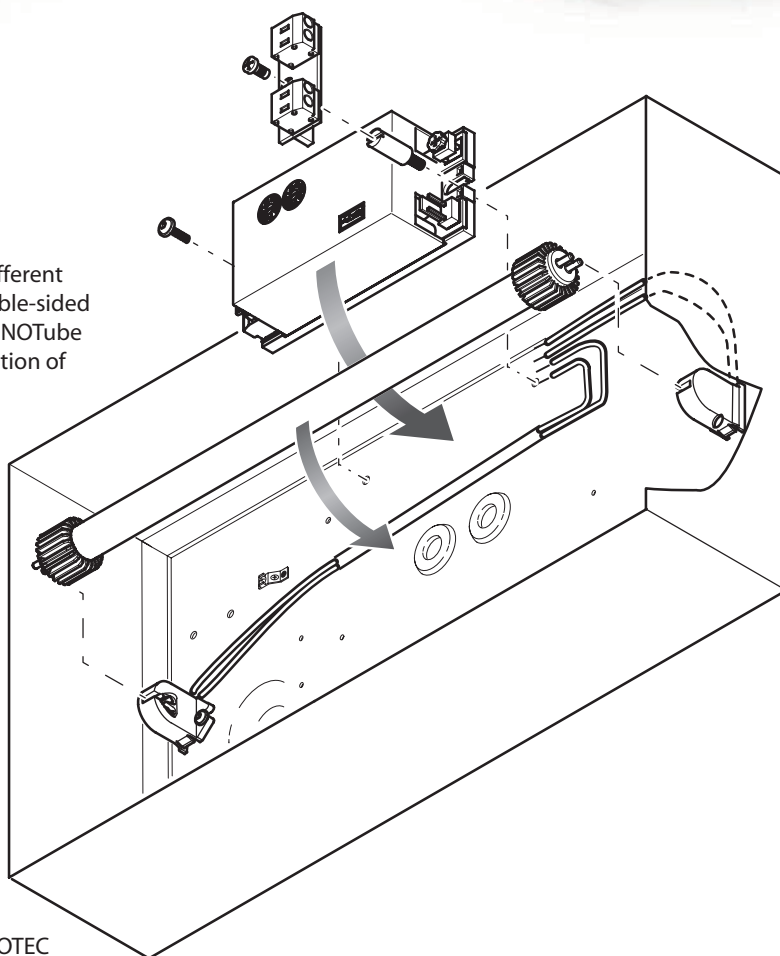

Easy luminaire modification

The INOTEC LED driver is the same size like the old INOTEC electronic ballast. Therefore it's possible to re-use the existing tapped holes to fix the new LED module into the luminaire.

LED conversion kits

for mounting in INOTEC Exit-luminaires with T5 fluorescent lamp

J/SV **SKÜ** **NE/SV**

LED conversion kit with 360° beam angle by innovative LED spotlighting. For conversion of INOTEC exit-luminaires with fluorescent lamp T5 (socket G5).

Technical data

Illuminant :	LEDs
Nominal voltage AC :	230V ± 10%, 50/60Hz
Nominal voltage DC :	220V ± 20%
Nominal current : I	8 mA
Power consumption :	5.2 VA
Terminals :	2.5 mm ² for feed-through wiring
Temperature ta :	-15°C... +40°C
Protection class :	I

acc. to DIN EN 60598-1, DIN EN 60598-2-22, DIN 4844-1 and DIN EN 1838

According to standards exclusiv INOTEC LED conversion kit.**INOTube conversion kit 8/360°**

In-luminaire mounting

Art. Nr. 890 214 - J/SV
Art. Nr. 890 234 - SKÜ
Art. Nr. 890 244 - NE/SV

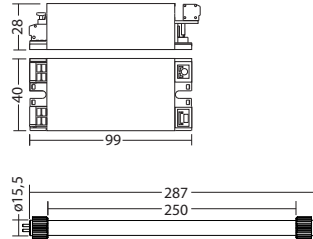
**INOTube conversion kit 6/360°**

In-luminaire mounting

Art. Nr. 890 216 - J/SV
Art. Nr. 890 236 - SKÜ
Art. Nr. 890 246 - NE/SV

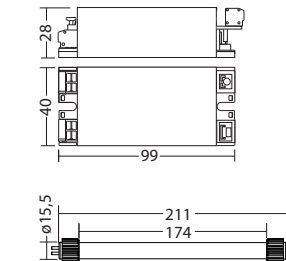

LED conversion kits

for mounting in INOTEC Exit-luminaires with T5 fluorescent lamp

J/SV

SKÜ

NE/SV

LED conversion kit with 180° beam angle by innovative LED spotlighting. For conversion of INOTEC edge lights with fluorescent lamp T5 (socket G5).

Technical data

Illuminant :	LEDs
Nominal voltage AC :	230V ± 10%, 50/60Hz
Nominal voltage DC :	220V ± 20%
Nominal current : I	8 mA
Power consumption :	5.2 VA
Terminals :	2.5 mm ² for feed-through wiring
Temperature ta :	-15°C... +40°C
Protection class :	I

acc. to DIN EN 60598-1, DIN EN 60598-2-22, DIN 4844-1 and DIN EN 1838

According to standards exclusiv INOTEC LED conversion kit.

INOTube conversion kit 8/180°

In-luminaire mounting

Art. Nr. 890 215 - J/SV
Art. Nr. 890 235 - SKÜ
Art. Nr. 890 245 - NE/SV

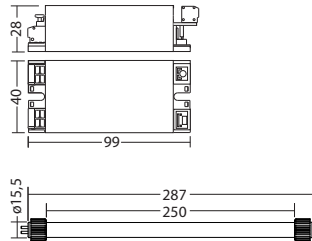

INOTube conversion kit 6/180°

In-luminaire mounting

Art. Nr. 890 217 - J/SV
Art. Nr. 890 237 - SKÜ
Art. Nr. 890 247 - NE/SV

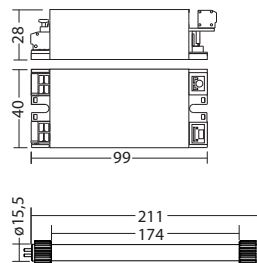



INOTEC Sicherheitstechnik GmbH
Am Buschgarten 17
D - 59 469 Ense

Tel +49 29 38/97 30-0

Fax +49 29 38/97 30-29

info@inotec-licht.de

www.inotec-licht.de

